

- KEY**
- CORE ACADEMIC
 - SPECIAL EDUCATION
 - VISUAL ARTS
 - PERFORMING ARTS
 - JROTC
 - MEDIA CENTER
 - PHYSICAL EDUCATION/HEALTH
 - BUSINESS EDUCATION/MARKETING
 - TECHNOLOGY EDUCATION
 - FAMILY AND CONSUMER SCIENCE
 - GUIDANCE AND STUDENT SERVICES
 - ADMINISTRATION
 - MAINTENANCE/CUSTODIAL
 - FOOD SERVICE
 - BUILDING SUPPORT
- ENTRIES**
- PRIMARY ENTRY
 - SECONDARY ENTRY

- ABBREVIATIONS**
- AD Administration
 - B Branch
 - BUS Business Classroom
 - C Changing Rm.
 - CONF Conference
 - COUN Counselor Office
 - CR Classroom
 - D Display Case
 - ELEC Electrical
 - LR Locker Room
 - MECH Mechanical Room
 - OFF Office
 - PAR Parent
 - PRINC Principle
 - R Reception Area
 - REC Recycling Area
 - SC Science Classroom
 - SG Small Group
 - SPEC Special Education
 - SS Side Stage Space
 - STOR Storage
 - T Time Out Rm.
 - V Vault
 - WR Workroom

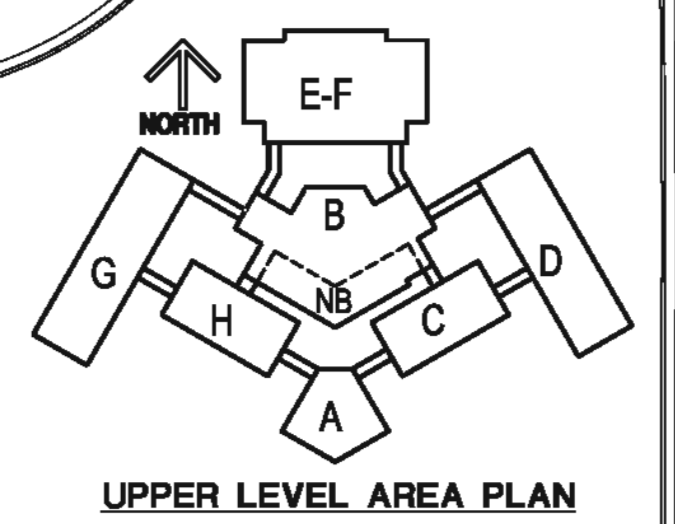
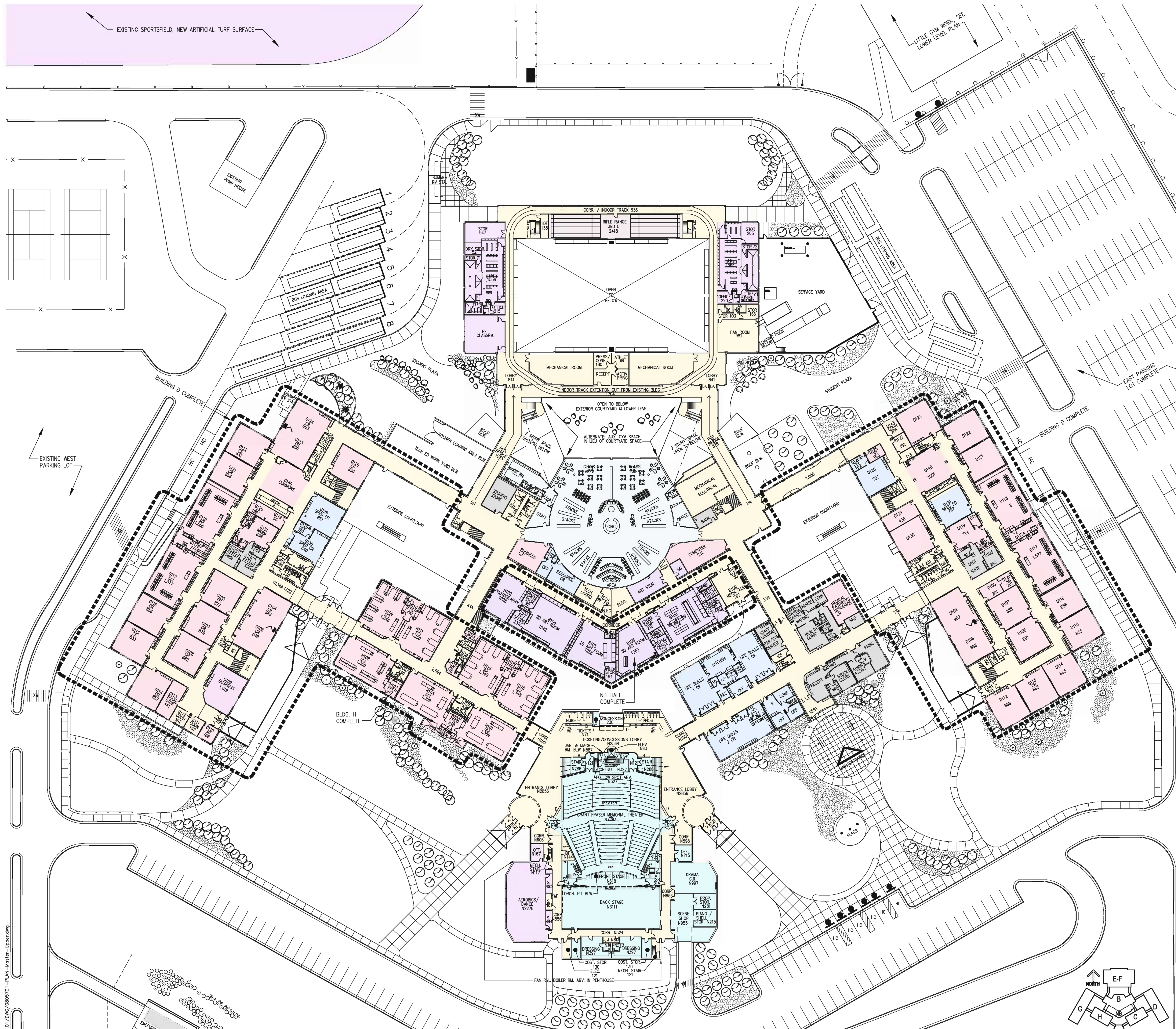

Architects Alaska
 Landscape Architecture
 Interior Architecture

900 West Fifth Avenue
 Anchorage, Alaska 99501
 (907) 272-3567

191 E. Swanson Avenue
 Wasilla, Alaska 99554
 (907) 375-7503

0 7.5' 15' 30' 60'
 SCALE: 1" = 30'-0" (FULL SIZE SHEET)

NORTH

DATE: DEC. 8, 2008

SERVICE HIGH SCHOOL RENEWAL PROJECT: ALTERNATE MASTER PLAN- UPPER LEVEL

**Service High School
Alternate Master Plan**

**SPACE SUMMARY
Attachment B
December 8, 2008**

	Approved 2000 Master Plan	Proposed Alternate Master Plan
Lower Level:		
Building Area A1 (New)	-	1,833
Building Area B1	47,191	46,565
Building Area D1	35,977	35,977
Building Area EF1	48,575	36,082
Building Area G1	37,037	37,037
Little Gym	-	8,686
Lower Level Totals	168,780	166,180
Upper Level:		
Building Area A (Demo)	11,003	(11,003)
Building Area A2 (New)	-	30,843
Building Area A3 (New)	-	1,663
Building Area B2	29,725	35,883
Building Area C	14,079	14,079
Building Area D2	29,831	29,831
Building Area EF2	18,580	17,925
Building Area G2	30,912	30,912
Building Area H	14,436	14,436
Building Links	7,709	6,837
	156,275	171,406
Mechanical Penthouses		
A Roof (Demolish)	290	(290)
A Roof Addition	300	-
B Roof (NB Hall)	136	136
C Roof	185	185
C Roof Addition	300	300
D Roof New	1,178	1,178
G Roof New	1,178	1,178
H Roof	529	529
Little Gym	-	132
Penthouse Totals	4,096	3,347
Building Totals	329,151	340,933

Notes:

1. Occupancy basis = 2,070 students.
2. 2000 Master Plan added Auxiliary Gym onto existing Gym (Building EF) and did not include use of the unattached 8,686 square foot "Little Gym".
3. Area calculations for both master plans are based on 1999 SOA-EED methods.
4. Mechanical areas are calculated at 25%.