

- KEY**
- CORE ACADEMIC
  - SPECIAL EDUCATION
  - VISUAL ARTS
  - PERFORMING ARTS
  - JROTC
  - MEDIA CENTER
  - PHYSICAL EDUCATION/HEALTH
  - BUSINESS EDUCATION/MARKETING
  - TECHNOLOGY EDUCATION
  - FAMILY AND CONSUMER SCIENCE
  - GUIDANCE AND STUDENT SERVICES
  - ADMINISTRATION
  - MAINTENANCE/CUSTODIAL
  - FOOD SERVICE
  - BUILDING SUPPORT
- ENTRIES**
- PRIMARY ENTRY
  - SECONDARY ENTRY

- ABBREVIATIONS**
- AD Administration
  - B Branch
  - BUS Business Classroom
  - C Changing Rm.
  - CONF Conference
  - COUN Counselor Office
  - CR Classroom
  - D Display Case
  - ELEC Electrical
  - LR Locker Room
  - MECH Mechanical Room
  - OFF Office
  - PAR Parent
  - PRINC Principle
  - R Reception Area
  - REC Recycling Area
  - SC Science Classroom
  - SG Small Group
  - SPEC Special Education
  - SS Side Stage Space
  - STOR Storage
  - T Toilets
  - TO Time Out Rm.
  - V Vault
  - WR Workroom

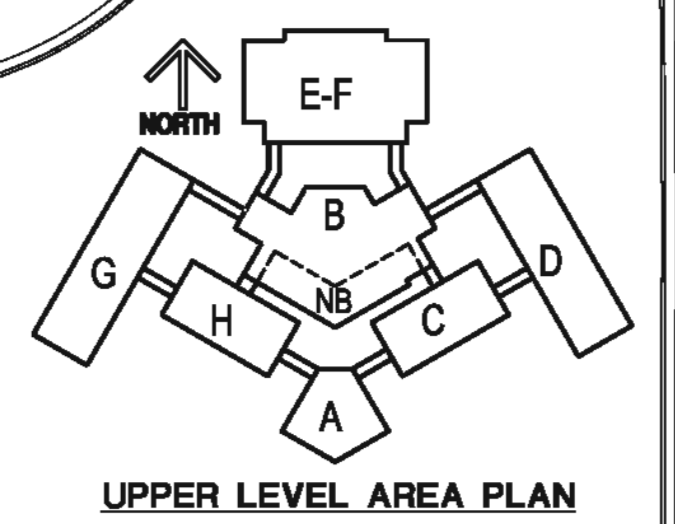
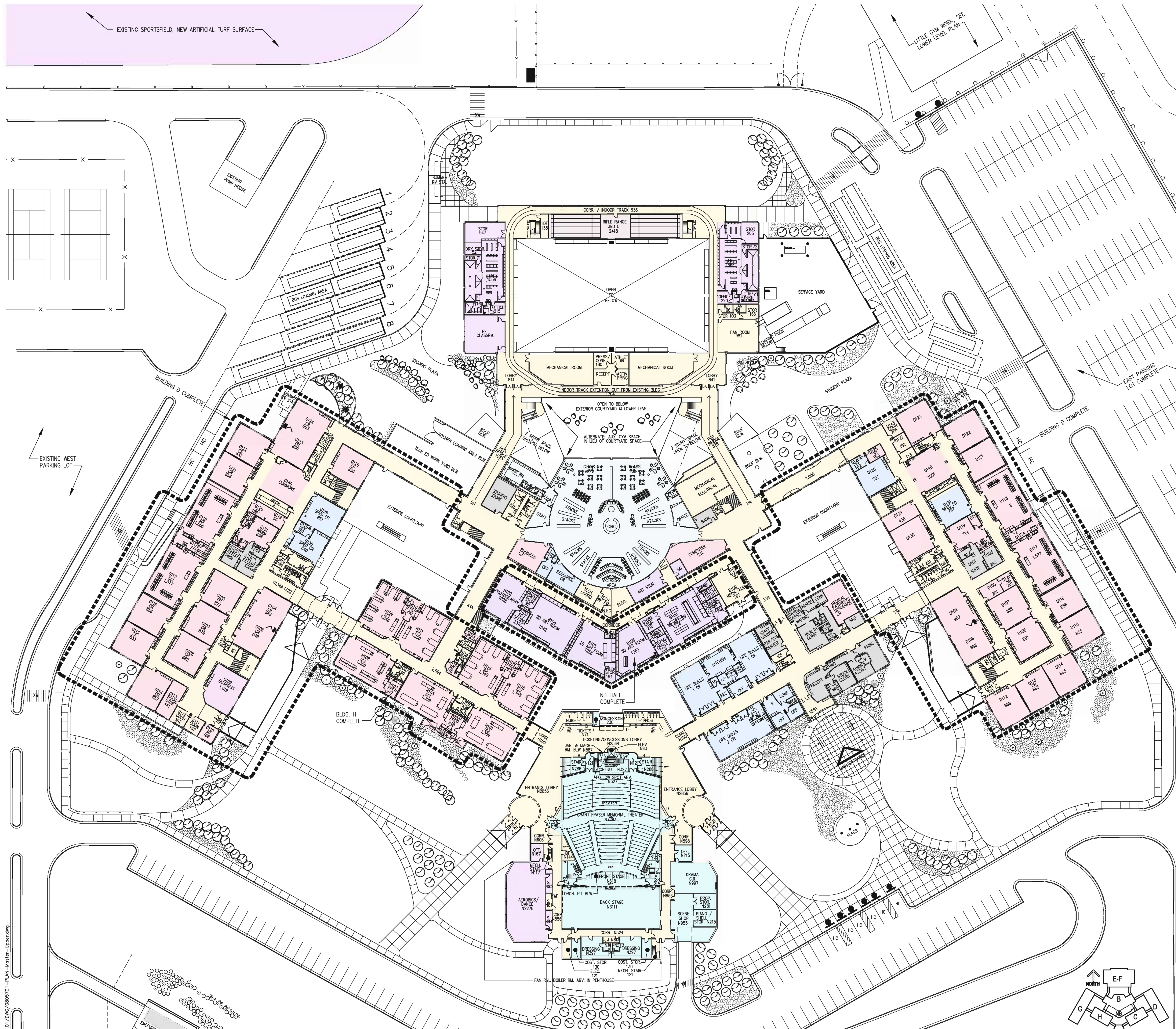

**Architects Alaska**  
Landscape Architecture  
Interior Architecture

900 West Fifth Avenue  
Anchorage, Alaska 99501  
(907) 272-3567

191 E. Swanson Avenue  
Wasilla, Alaska 99554  
(907) 375-7503

0 7.5' 15' 30' 60'  
SCALE: 1" = 30'-0" (FULL SIZE SHEET)

**NORTH**

DATE: DEC. 8, 2008

**SERVICE HIGH SCHOOL RENEWAL PROJECT: ALTERNATE MASTER PLAN- UPPER LEVEL**

FILE: 08057.01/DWG/0805701-PLAN-Master-Upper.dwg